



深圳市龙桥科技发展有限公司

SHENZHEN DRAGON BRIDGE TECHNOLOGY LTD COMPANY

Application :Rental cars, insurance cars, trucks, buses

Wireless Fleet management Solution Innovator

GSM/GPRS/GPS Tracker

User Manuel

LLS-100T



Contents

| | |
|---|---|
| 1 Introduction..... | 2 |
| 1.1 product description..... | 2 |
| 2 Product Overview..... | 2 |
| 2.1 Product accessories..... | 2 |
| 2.2 Device LED light and push-button..... | 2 |
| 2.3 Parameters..... | 3 |
| 2.4 Function..... | 5 |
| 2.5 Application..... | 5 |

1 Introduction

1.1 product description

The LLS-100T is a positioning terminal specially designed for marine positioning monitoring applications. LLS-100T can realize the position monitoring and tracking of outdoor valuable assets such as ships through GPS/BD satellite positioning technology, solar charging technology, GSM/GPRS communication technology, and multi-mode flexible configuration of location service monitoring and management system. The device has a tamper-evident alarm function, and the management center can monitor the device in real time. At the same time, it also has a one-button alarm function. In case of emergency, it can send an alarm to the management center through the button.

2 Product Overview

2.1 Product accessories

| Items | description |
|-------------|---|
| Main device |  |

2.2 Device LED light and push-button

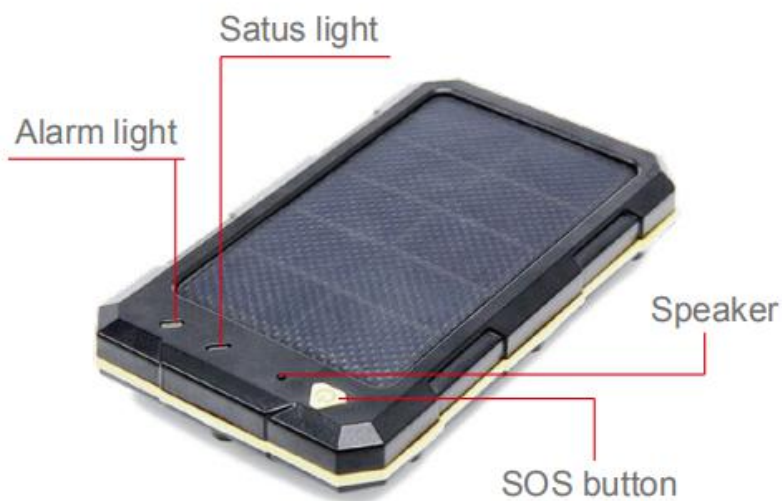

Status light ---- corresponding working status

Green light indicates GPS status:

1. No positioning: 4 seconds cycle, 2 seconds interval on and off;
2. Positioning: 4 seconds period, 0.5s on and 3.5s off

Red light indicates GSM status:

1. If the card is not found, the red light is always on;
2. If the card is found but GSM is not registered, it will turn on and off in 2 seconds;
3. Register for GSM, no GPRS, fast flash once in 4 seconds;
4. With GPRS, flash 2 times in 4 seconds

Note:

Press and hold the sos button for 3 seconds, the SOS alarm will be triggered, the buzzer will sound and the white light flashes 3 times quickly

Inside:

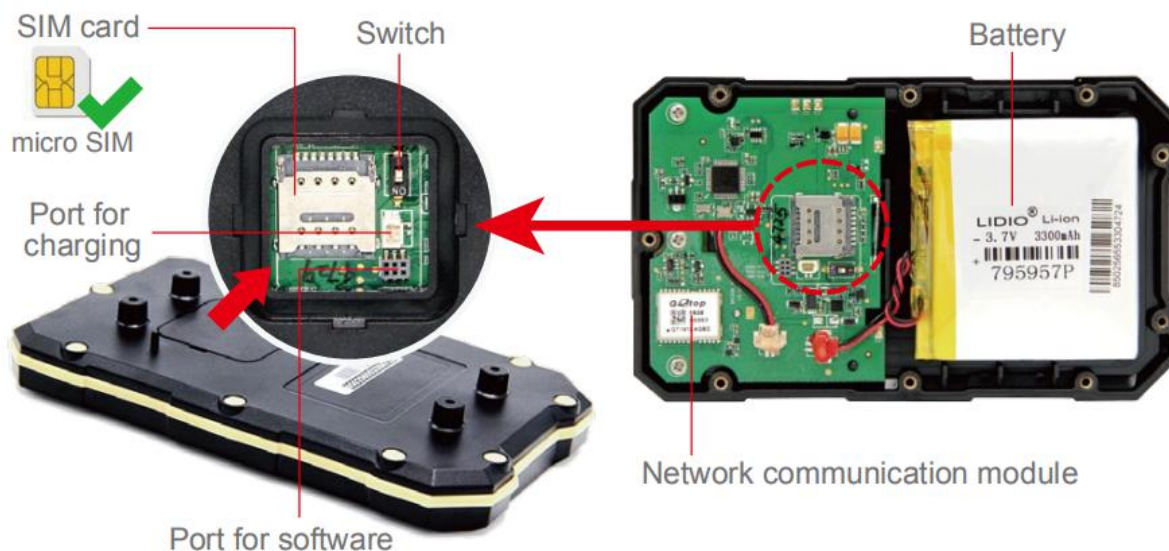

2.3 Parameters

| Items | description |
|------------|---|
| Platform | Low-power MCU+(CDMA/GPRS module)+GPS/Beidou dual-mode positioning module+G sensor |
| GSM module | GSM850/GSM900/DCS1800/PCS1900 (Optional for 4G Version) |
| Dimensions | 135mm*80mm*19mm (excluding the base) |

| | |
|--|---|
| Weight | 177g |
| Solar panel specifications | Single crystal gauge, voltage 5.5V, current 200mA, conversion rate 21.5% |
| Battery capacity | 3000mAh Lithium polymer battery |
| GNSS type | Beidou/GPS dual mode |
| A-GNSS Auxiliary | Support |
| Applicable environment | -20 C ~75 C |
| Working humidity | 30%-95% RH does not clot |
| Module of 4G Version (optional) (Quectel, EC20 R2.1 for samples) | LTE FDD:B1/ B3/ B5/ B8 LTE TDD :B38/ B39/ B40/ B41 WCDMA: B1/ B8 TD-SCDMA B34/ B39 3G: CDMA: BC0 GSM:900/1800MHz |
| GPS chip | MTK AG3331 (The whole: GT1612-AGBD) |
| Tracking sensitivity | -165dBm |
| Capture sensitivity | -156dBm |
| Acquisition | 148dBm |
| Positioning accuracy | <10 meters |
| CPU | STM32L151CCT6 |
| Channel | 66 search channels and 22 simultaneous tracking channels |
| Acceleration Accuracy | 0.1M/S ² |
| Acceleration sensor | KX022-1020, LGA-12, KIONIX |
| Dynamic Performance | Maximum altitude: 18,000m; Maximum velocity: 515m/s; Acceleration: 4G |
| Search time | Hot start 1S Cold start 40S (open conditions) |
| Protection level | Waterproof IP67 |
| Material of Shell | ABS+PC |

2.4 Function

1. Supervision of the daily position of small fishing vessels;
2. Navigation track management;
3. Supporting blind zone supplements;
4. Solar charging, no external power supply is required, the power can be inquired, and the low-power active alarm;
5. Support tamper alarm;
6. Support one-button emergency alarm, except alarm, sound and light reminder;
7. The product meets the IP67 three-proof standard and is resistant to salt spray corrosion;
8. Having a solar charge status inquiry;
9. Flexible setting of the location upload interval, respectively, setting the parking and uploading data upload interval;
(The original setting is to upload data every 30 minutes when the vessel is stopped. Upload data every 5 minutes when you ship)
10. has low power protection function;

2.5 Application



A. Fix on Metal handrail

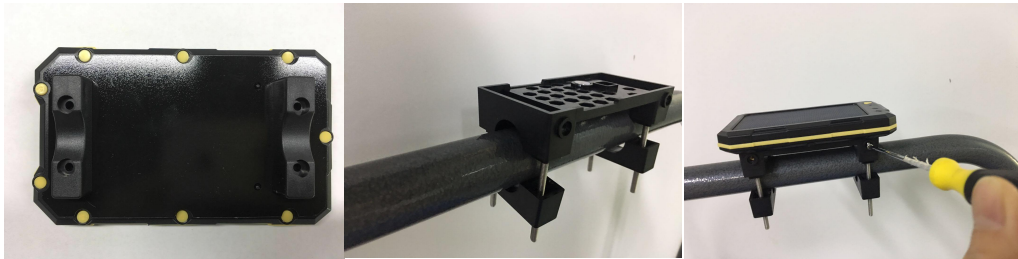

Application: Cruise, lighthouse, infrastructure

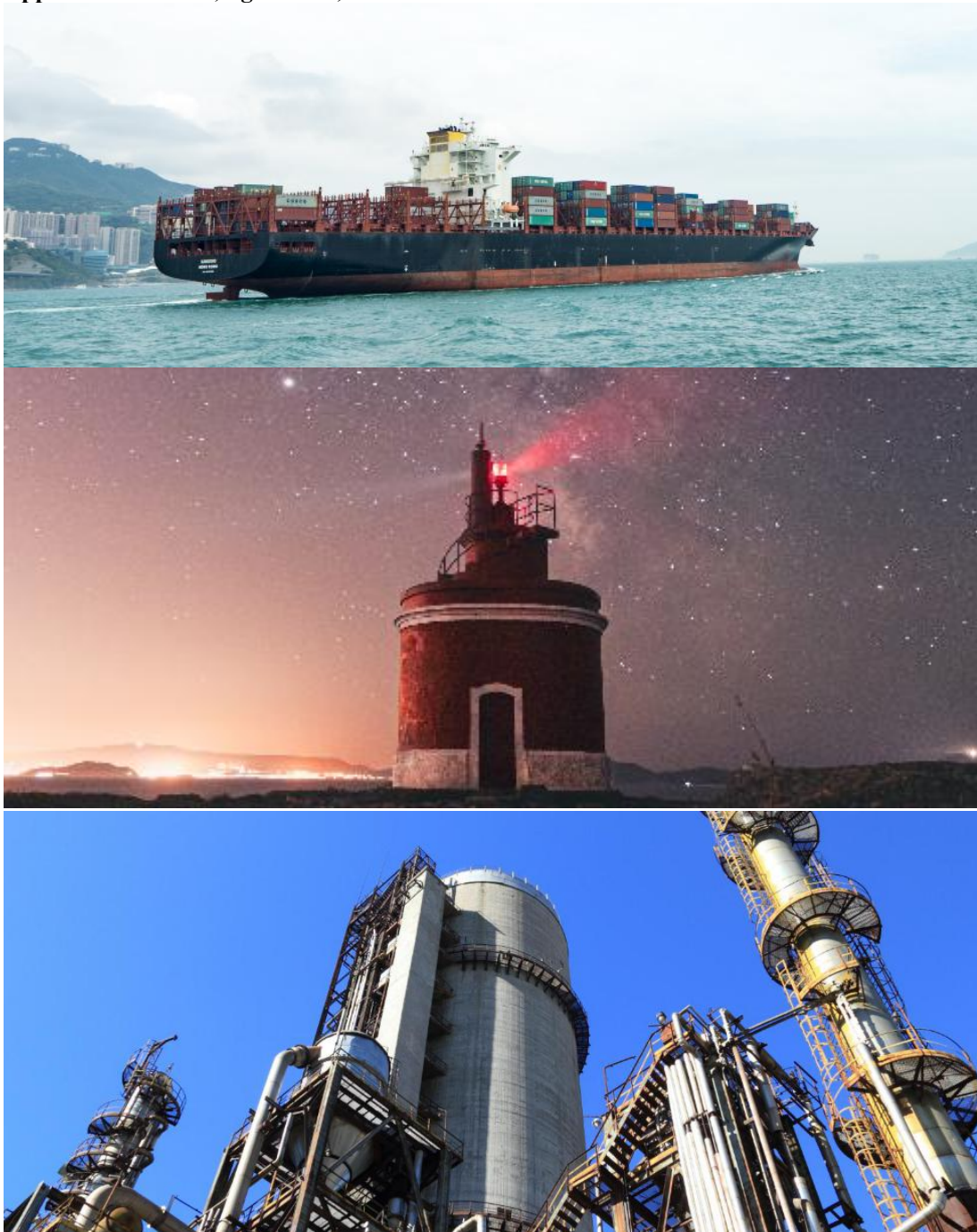

B. Fix with mental protective shell .

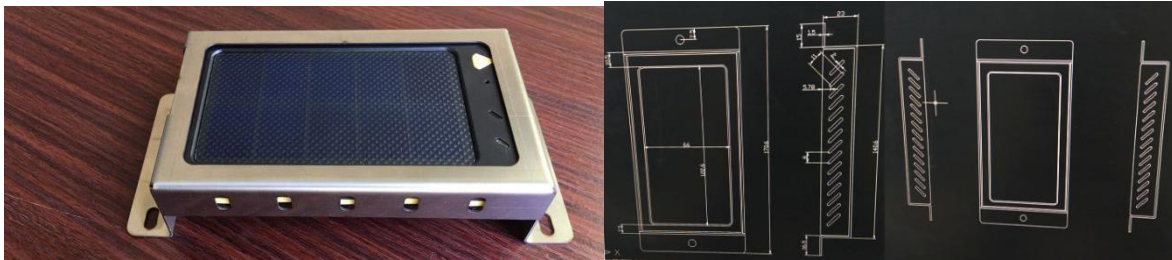

Application: Container, Container truck, trailer

